

D7821 D7822 D7823 D7824

True Diversity UHF Wireless Microphone System



D7821 (Receiver × 1 + Handheld Microphones × 2)



D7822 (Receiver × 1 + Lavalier Microphones × 2 + Bodypack Transmitters × 2)



D7823 (Receiver × 1 + Headset Microphones × 2 + Bodypack Transmitters × 2)



D7824 (Receiver × 1 + Desktop Microphones × 2)

Description

The D7821 D7822 D7823 D7824 True Diversity UHF Wireless Microphone System offers stable signal transmission over 150 meters with a UHF frequency range of 610MHz-690MHz. It features True Diversity technology, a signal-to-noise ratio of $\geq 105\text{dB}$, and up to 7 hours of battery life. This system is perfect for professional audio applications such as conferences, live performances, and events, ensuring clear, reliable sound in various environments.

Features

- Dual-channel diversity design with PLL phase-locked loop frequency control.
- True Diversity Technology for stable signal reception.
- Transmission range up to 150 meters.
- UHF frequency range of 610MHz-690MHz.
- Signal-to-noise ratio of $\geq 105\text{dB}$ for high-quality audio.

- Approximately 7 hours of battery life for extended use.
- 200 RF channels with 300KHz spacing for flexibility.
- Wide frequency response from 45Hz to 16kHz.
- Ideal for professional applications like conferences and live performances.
- Compact and user-friendly design for easy setup.
- Professional stage, UHF PLL design, excellent sound quality, multiple channels available.

Specifications

Model		D7821	D7822	D7823	D7824
Receiver	Channel Configuration	Diversity dual-channel			
	Operating Frequency Range	UHF 610MHz-690MHz			
	Frequency Stability	±0.005%, PLL Frequency Control			
	Effective Transmission Distance	150 meters (Open Environment)			
	Sensitivity	-98dBm			
	Audio Performance	Maximum Deviation: ±75KHz Frequency Response: 45Hz-16kHz (±3dB) Signal-to-Noise Ratio (S/N): ≥105dB (1KHz-A weighted) Total Harmonic Distortion (T.H.D.): ≤0.5%			
	Output Interface	XLR balanced output, Ø6.3mm unbalanced output (maximum output +10dB)			
	Power Supply	DC12V/1A			
Transmitter	Operating Frequency Range	610MHz-690MHz			
	Modulation Mode	Wideband FM			
	Channel Features	Supports 200 Channels, 300KHz Channel Spacing			
	Pickup Type	Dynamic, Cardioid	Condenser	Condenser	Condenser
	Transmission Power	<10mW			
	Antenna Type	Built-in Antenna			
	Audio Performance	Frequency Response: 45Hz-16kHz (±3dB) Spurious Suppression: -50dB			
	Power Supply	2 AA	Alkaline Batteries (Supports approximately 7 hours of operation)		
	Effective Transmission Distance	150 meters (Ideal conditions)			
	Operating Temperature Range	-10℃ to +50℃			

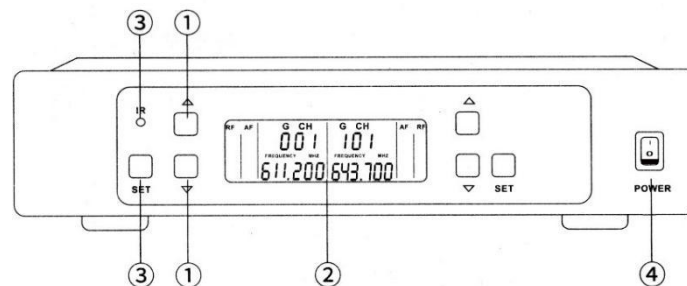

- ① Function Buttons: Used for channel selection, frequency adjustment/synchronization/scanning, etc.
- ② LCD Display: Displays synchronization status, frequency, reception signal level, and more.
- ③ IR Synchronization Window: Transmits frequency parameters to the transmitter, used in conjunction with the [SET] button.
- ④ Power Switch: Controls the receiver's power.

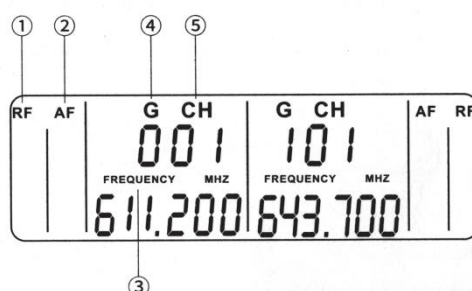

LCD Display

- ① RF Indicator: Displays the received signal strength.
- ② AF Indicator: Displays the audio signal strength.
- ③ FREQUENCY: Displays the operating frequency.
- ④ G: Displays the default group.
- ⑤ CH: Displays the faulty channel.

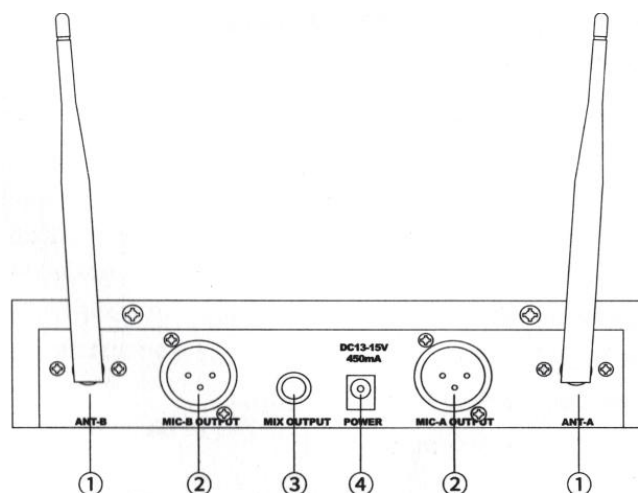

- ① Antenna: A/B Antenna.
- ② Balanced Audio Output: XLR connectors providing independent signal output for each channel.
- ③ Mixed Audio Output: Mixes audio signals from two channels into a single output.
- ④ Power Socket: Connects to a DC 12V power supply; the center pin is connected to positive voltage.

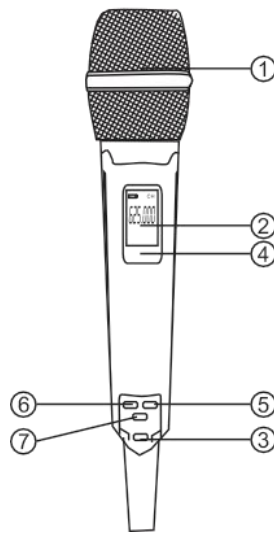

- | | |
|---------------------------|-----------------|
| ① Microphone Head | ⑤ Up Button |
| ② LEC Display | ⑥ Down Button |
| ③ Power Switch | ⑦ Set Key/Point |
| ④ Infrared Frequency Port | |

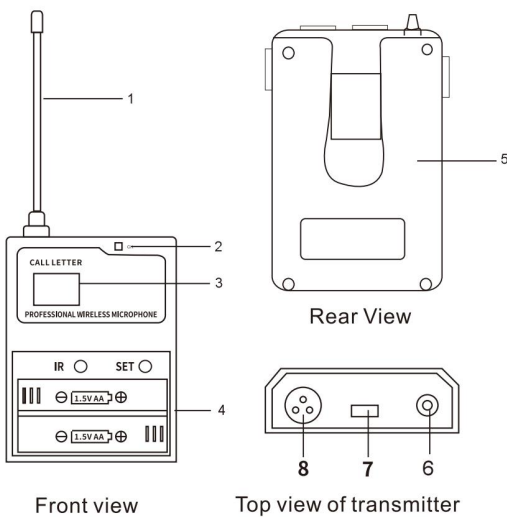

- | |
|---------------------------|
| ① Microphone Head |
| ② LEC Display |
| ③ Power Switch |
| ④ Infrared Frequency Port |
| ⑤ Up Button |
| ⑥ Down Button |
| ⑦ Set Key/Point |

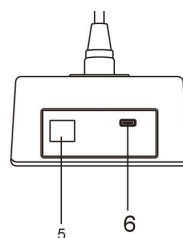
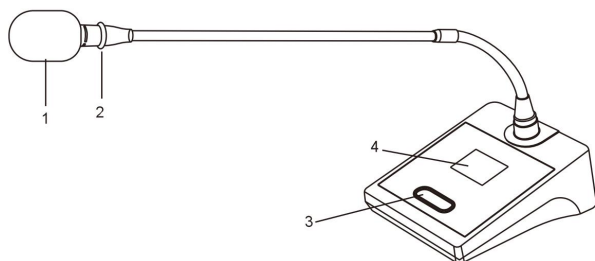

- | |
|---------------------------------------|
| ① Super Directional Capacitive Pickup |
| ② Light ring: Always on When Speaking |
| ③ Microphone Switch Key (ON/OFF) |
| ④ Display Screen |
| ⑤ Infrared Frequency Window |
| ⑥ Charging Port |